

DIY Hardware Package

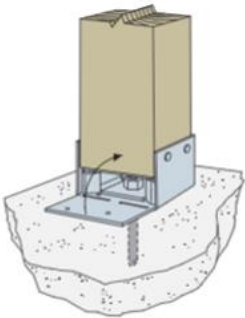

Metal Post Anchor 6 x 6: If you installed Diamond Piers, use the nut and washer included with the Diamond Pier.



5" LedgerLOK: Minimum 3-3/4" from ends and 2" from top/bottom edge. V-pattern. Refer to the Academy for spacing requirements.

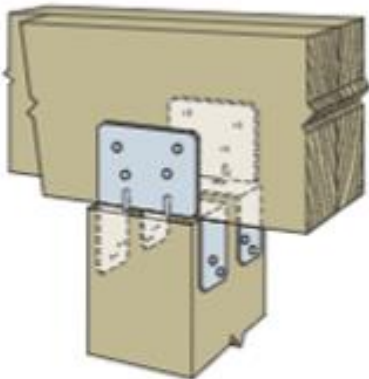

Post to Beam Bracket

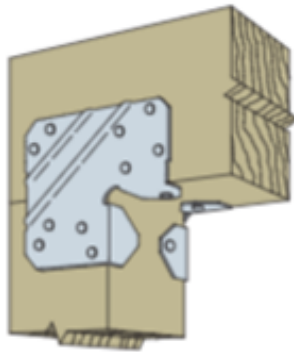

Corner Post Cap

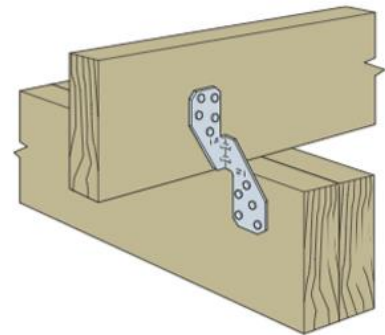

Hurricane Tie: used for attaching joists to a drop beam.

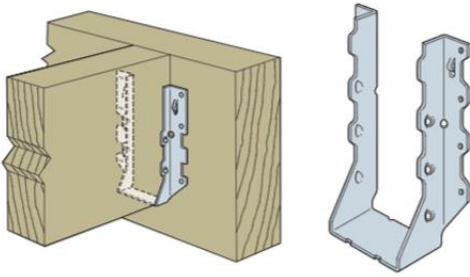

2x10 Hangers for joists and beams. Can also be used for 2x12 material. **REQUIRES 2 DIFFERENT SIZED NAILS TO ATTACH** (see below).

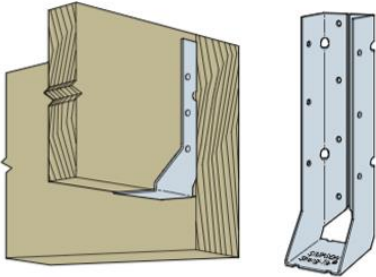

2x10 **CONCEALED** Hangers: use these on the ends of your ledger and beams. Can also be used for 2x12 material.

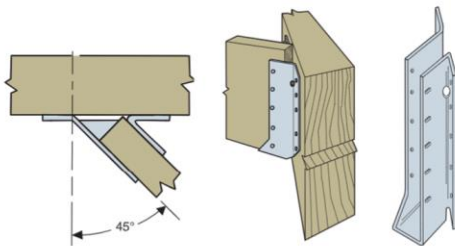

SUR/SUL Skewed Joist Hanger
45° skewed hanger (available in skewed right and left versions), provides bearing and uplift resistance. ZMAX® coating or stainless steel required.

2x10 **SKEWED** Hangers: use these on the ends of your ledger and beams. Can also be used for 2x12 material.



1 1/2" Hot-Dipped Galvanized Joist Hanger Nails: These nails must fill every hole on the hanger tabs and are attached straight into the ledger - **DO NOT** attach these nails in the angled holes.

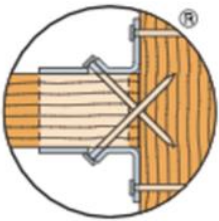

Double-Shear Nailing



3" Hot-Dipped Galvanized Joist Hanger Nails: These nails must fill every angled hole.



16D Galvanized Box 3 1/2" Nails: Used to attach hangers to beams, post to beam hanger, and for nailing plys of beam together. For building your beam plys, alternate between nails and the 2 1/2" Deck Screws in a row of 4 fasteners every 12" on both sides of the beam.

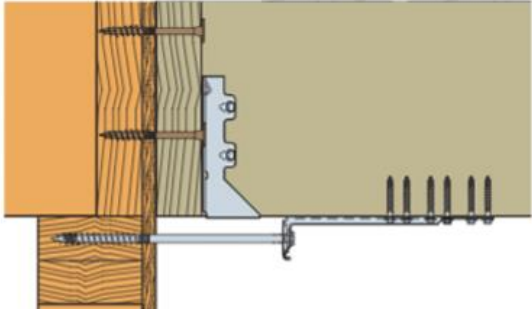

DTTZ-1 Lateral Brackets (4):
Evenly spaced under deck. Place outside brackets no more than 2' from ends of deck. Use 1-1/2" joist nails and the included lag screw to attach. Can be attached along the bottom or side of the joist. Inspectors want to see them attached to 3" of material - the rim joist or top plate of the basement wall. Refer to online University for more attachment options.

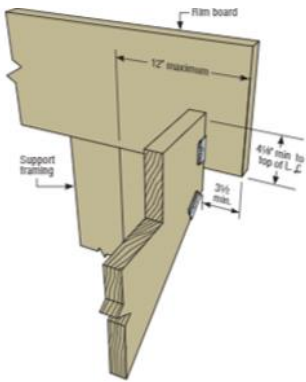

Adjustable Stringer Connector:
attach the heel of the stringer to the deck. Please refer to the Academy on how to build support framing below the rim joist.



3 5/8" LedgerLOK Screw: for attaching aluminum railing posts to framing/blocking through the decking.
*Don't confuse these with the 5" screw used on the ledger board.

DecXorators®



- Deckorators Stowaway Hidden Fasteners are used for installing your main grooved edge decking boards. Stowaway hidden fasteners come in quantities of 90 and/or 525.



- Deckorators Pro Plug System (cortex) is a screw and plug system. These screws and plugs are to be used when installing your solid edge boards. Solid edge boards are commonly used as the picture frame and stair treads.



- Deckorators CAP-TOR xd screws are going to be color matched to your decking and/or fascia. These screws are to be used when installing your fascia around the perimeter of your deck and on the sides of your stairs. These screws are also to be used on your riser boards. The screw is meant to be screwed in, so the head is flush with the outside of the fascia/riser. ****If you drive it in all the way with the tool, you will go through the board****



- TimberTech/Azek CONCEALoc Hidden fasteners are to be used on your main grooved edge decking.



- TimberTech/Azek (cortex) is a screw and plug system. These screws and plugs are to be used when installing your solid edge boards. Solid edge boards are commonly used as the picture frame and stair treads.



- TimberTech/Azek screws are going to be color matched to your decking and/or fascia. These screws are to be used when installing your fascia around the perimeter of your deck and on the sides of your stairs. These screws are also to be used on your riser boards. The screw is meant to be screwed in, so the head is flush with the outside of the fascia/riser. ****If you drive it in all the way with the tool, you will go through the board****



- Trex Universal Hidden fasteners are to be used on your main grooved edge decking.



- Trex (cortex) is a screw and plug system. These screws and plugs are to be used when installing your solid edge boards. Solid edge boards are commonly used as the picture frame and stair treads. **Not all Trex Lines have cortex. Some require TrapEase 3 Color Match Screws**



- Trex TrapEase 3 screws are going to be color matched to your decking and/or fascia. These screws are to be used when installing your fascia around the perimeter of your deck and on the sides of your stairs. These screws are also to be used on your riser boards. The screw is meant to be screwed in, so the head is flush with the outside of the fascia/riser. Some Trex lines will require these to install your Solid Edge boards **If you drive it in all the way with the tool, you will go through the board**